

4182 CRESTA DRIVE
SANTA BARBARA, CALIFORNIA
OFFERED AT \$6,395,000
WWW.4182CRESTADRIVE.COM

APN:	063-141-012	Bedrooms:	3 plus Guest House
Acres:	3.91	Bathrooms:	3.5 plus Guest House
Year Built:	1958-Remodeled	Square Footage:	5,165 Main House 1,587 Guest House

Mention Hope Ranch to old-time Santa Barbara residents and they will remember over the decades of time Hope Ranch providing many things to its various occupants: a Chumash settlement, a cattle ranch, a railroad right-of-way, a profitable lemon orchard, a popular picnic area and, thanks to Harold S. Chase, a planned rural equestrian, family-oriented community in the midst of a rapidly growing Santa Barbara County.

"Casa Cresta" is a stunning single level estate, an architecturally exquisite fusion of traditional and contemporary design, which incorporates the finest, globally sourced materials, custom workmanship and incredible attention to detail.

The home spans over 7,000 sq. feet of comfortable living and entertaining space on just under four acres. This private, gated estate offers formal living and dining rooms, library/game room, gourmet kitchen, master suite with adjoining exercise room and two additional bedrooms with en-suite baths in the main residence. There is a spacious separate guesthouse with private entrance.

Everything within the walls was creatively designed and implemented in the remodeling process of the home. Amazing detail permeates the entire residence featuring ebonized pegged oak flooring, custom windows and doors, walnut shoji screens, polished mesquite stone walls, state of the art sound system and entertainment bar. The kitchen features new anigre heavy figured custom cabinets with birch and stainless steel accents and black galaxy granite counters to promote interest and a sense of timelessness.

The extraordinary landscape plan for the property includes a total renovation of over 2 acres of the property. A 7,000 gallon koi pond, oversized spa and a 40-foot infinity fountain setting off the view of the mountains and the city to the north. A professional mixture of drought resistant materials, roses, agave and succulent gardens. An organic garden is off the kitchen for fresh herbs and vegetables. Trees include oak, avocado, lemon, lime, macadamia nut, persimmon, tangerine and orange along with other varieties. There is an extensive use of natural stone on the hardscape. Patios are Colorado quartzite, bluestone pavers and large granite boulders imported and strategically placed around the site.

Two notable features of the courtyard garden, including the koi pond, are the New England granite slab wall (aka Stonehenge) which provides separation from the south lawn area to the front courtyard and a dry rock stream bed which seasonally brings forward an exciting watercolor of plants including, blood grass, star jasmine, agapanthus, orchids, rock roses, a variety of blubs, grasses, plants and ground cover.

This signature property offers all of the amenities sought by the most discriminating of buyers. A tranquil, peaceful environment one is privileged to call home.

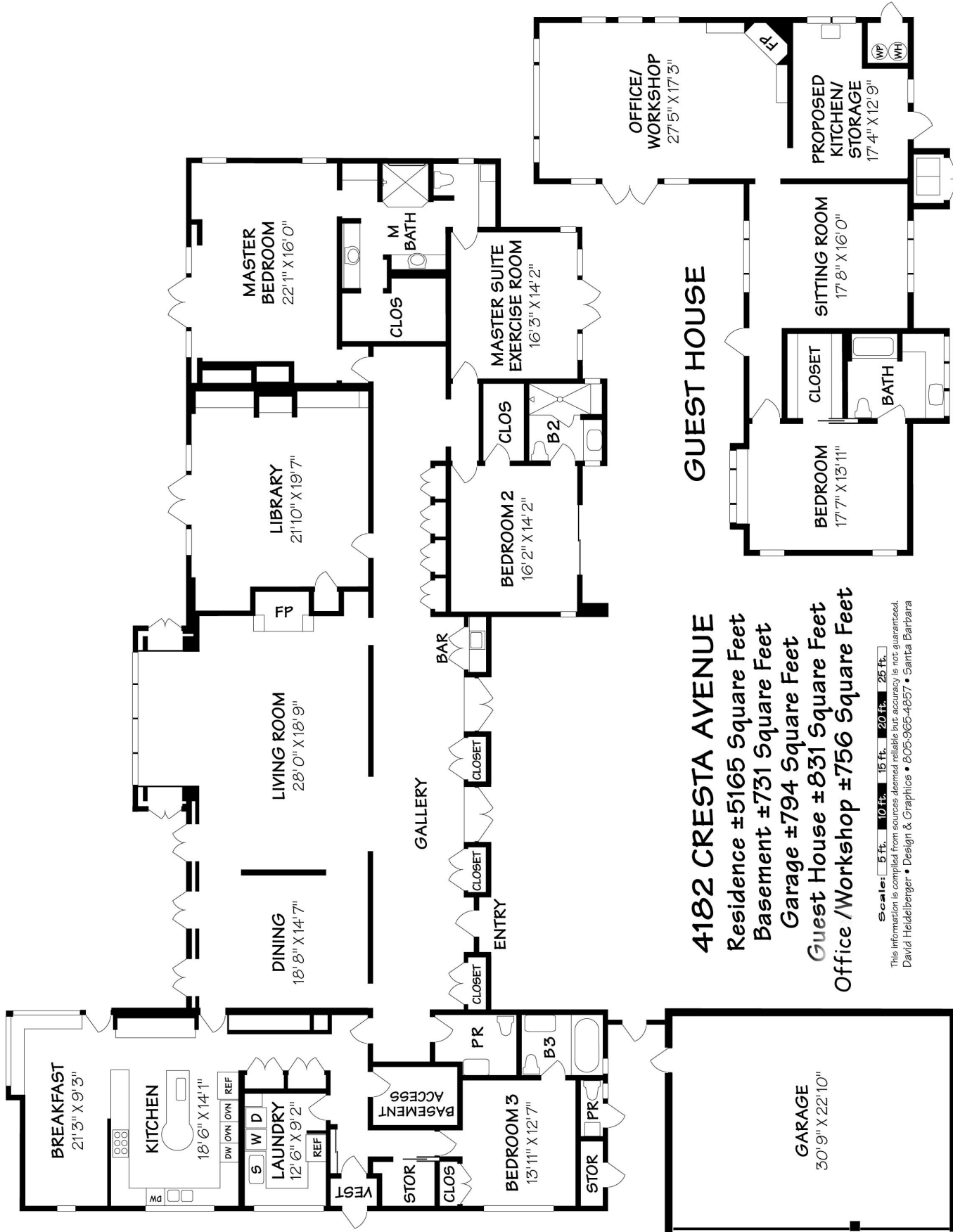

4182 CRESTA AVENUE

Residence ±5165 Square Feet
 Basement ±731 Square Feet
 Garage ±794 Square Feet

Guest House ±831 Square Feet
 Office /Workshop ±756 Square Feet

Scale: 5 ft. 10 ft. 15 ft. 20 ft. 25 ft.
 This information is compiled from sources deemed reliable but accuracy is not guaranteed.
 David Heidelberger • Design & Graphics • 805-965-4857 • Santa Barbara

* Information deemed reliable, but not guaranteed.